

# INSTRUCTION MANUAL

## 2.4GHZ SYSTEM

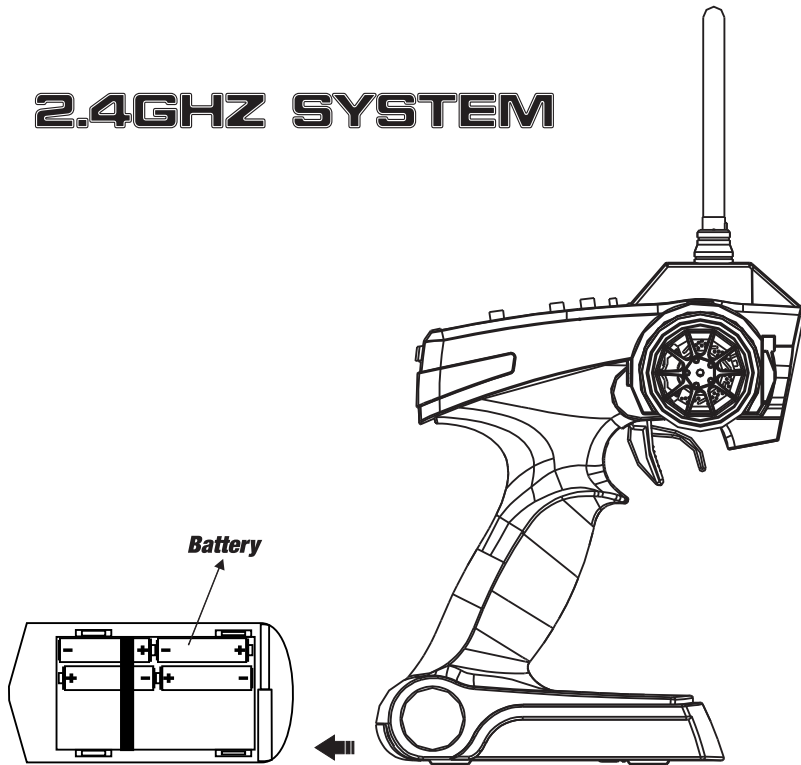

### Install the batteries

- (1) Remove the battery compartment cover.
- (2) Replace the used batteries with new AA size batteries.

Please replace batteries when the power indicator blinks or the buzzer beeps.

### Each part of the transmitter

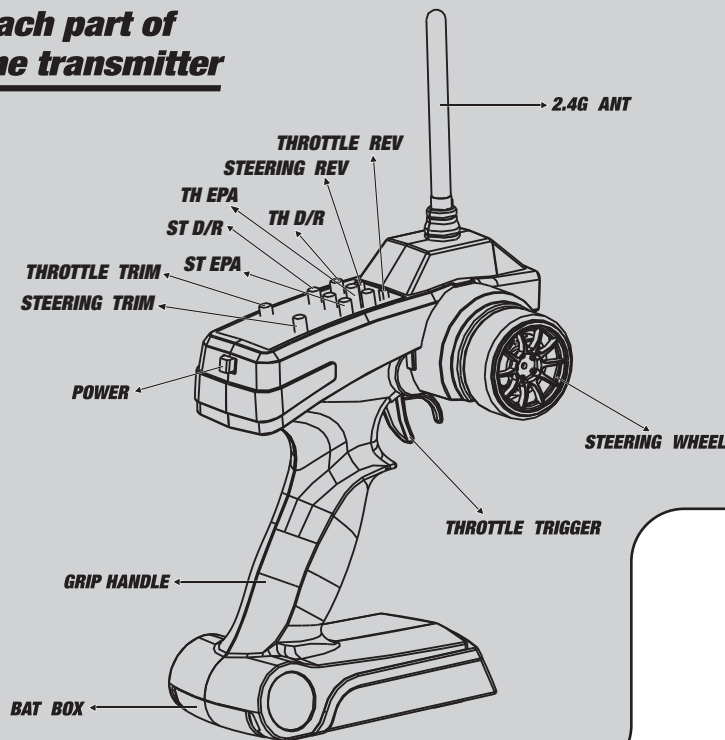

### The receiver function

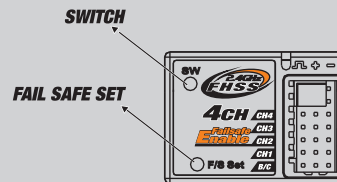

#### **Connectors**

- 1: Steering servo (CH1)
- 2: Throttle servo (CH2)
- 3: CH3 servo (CH3)
- 4: CH4 servo (CH4)
- B/C: Power connector

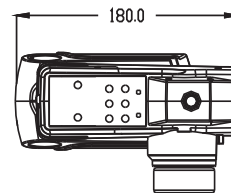

### The transmitter size

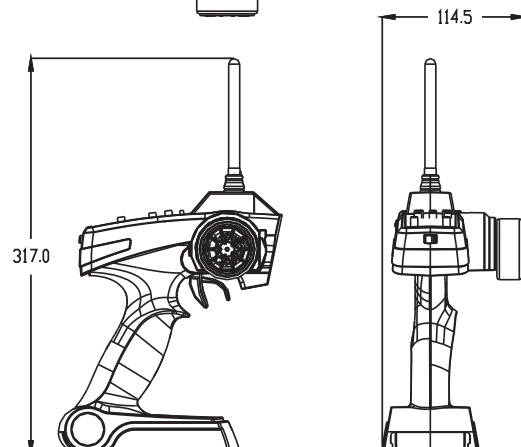

### The receiver size

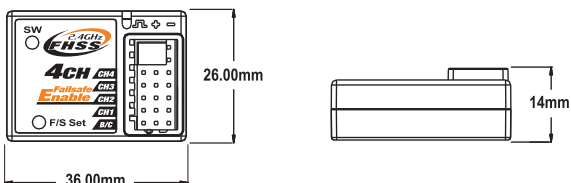

## Transmitter Adjustment

### A. Throttle Trigger

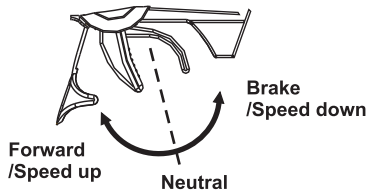

1. Push the trigger forward to slow down or brake.
2. Pull the trigger backward to accelerate.

### B. Steering Wheel

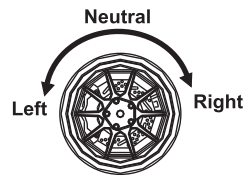

Turn the steering wheel to the left or right to let the vehicle turn left or right



Keep the transmitter and receiver 40cm apart when operating.

## Low battery alarm

Do not operate the radio system when the battery power is low.

## Fail Safe Function Setting

1. Set the TH, ST switches to the normal position.
2. Turn on the transmitter and receiver.
3. Press the F/S SET button, the LED on the receiver should start flashing rapidly.
4. Put the throttle trigger at the brake position, press the F/S SET button, the LED should become solid.
5. For electric model, put the throttle trigger at the stop position when you are making the setting.

## 2.4GHz

### Binding the transmitter and receiver

1



1. turn on the receiver power. Press the SW switch. The receiver's LED should start flashing.

2

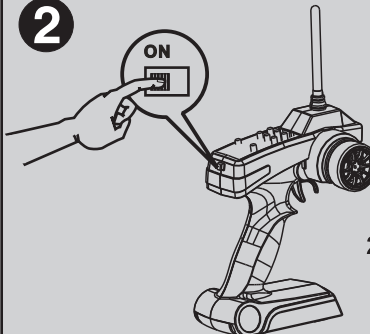

2. Turn on the transmitter.

3

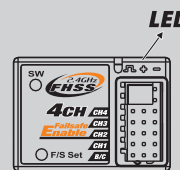

3. When the LED on the receiver becomes solid, the binding process is completed.

## Receiver and servo connection

### Electrical powered model

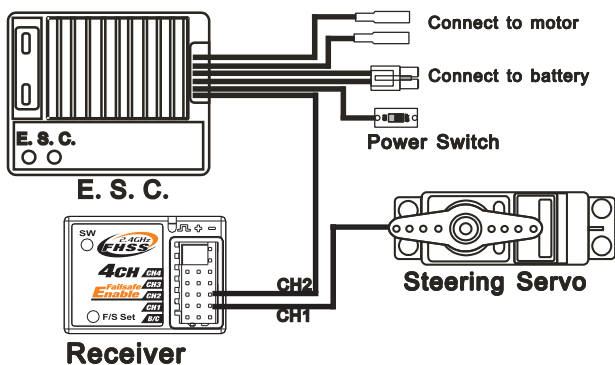

### Gas powered model

